

Grand Fire Outdoor Kitchen Installation Fast Guide

Please remove all the packing materials with care. Check if the product is perfect before you start. Any damage is found, please do not process and contact your dealer.

Tool need:

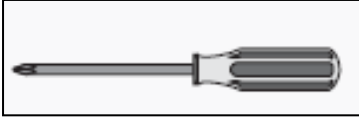

Phillips Head
Screwdriver

Step 1: Install the adjustable foot

Please lie down the unit on a friendly foam sheet or cardboard on flat ground. Install all four adjustable feet as below picture. There is no need of tool for the foot installation.

Step 1:

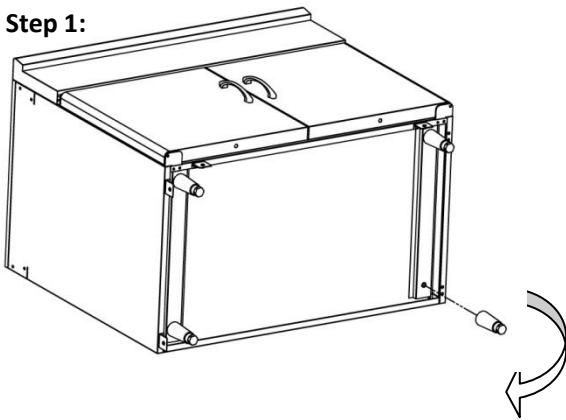

Step 2:

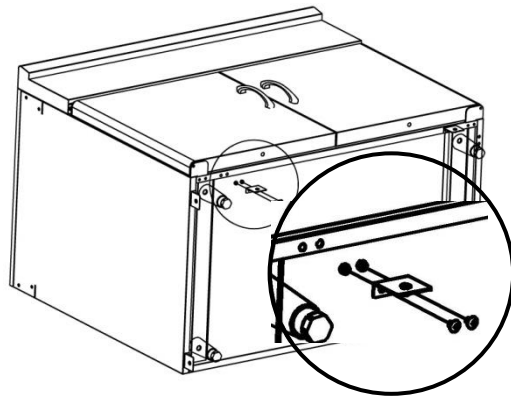

Step 2: Install the trim tabs

Install the trim tabs as picture shown below. The tabs and trim are for customer who wants the trim. If customer does not want the trim, please go step 3.

Step 3: Adjust the height

Have the unit stand beside other units you have. Adjust the height by turning low part of the foot as shown below for high or low level.

Step 3:

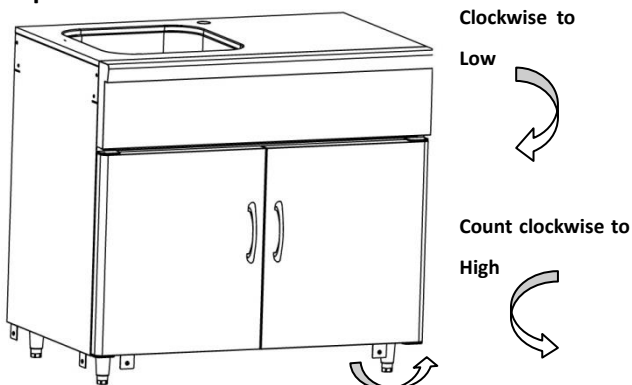

Step 4:

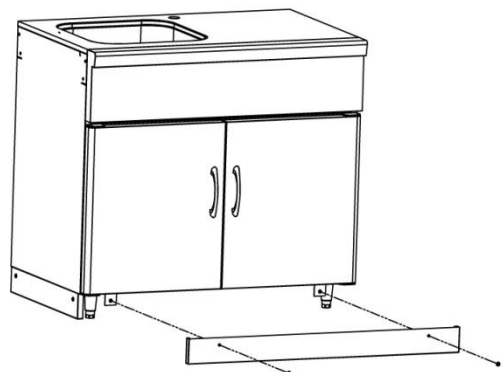

Step 4: Install the trim

Put the trims on front or side as shown in the picture. Use a screw driver to fasten the screws.



www.grandfirebbqs.com.au